

## Taper Milling Jig

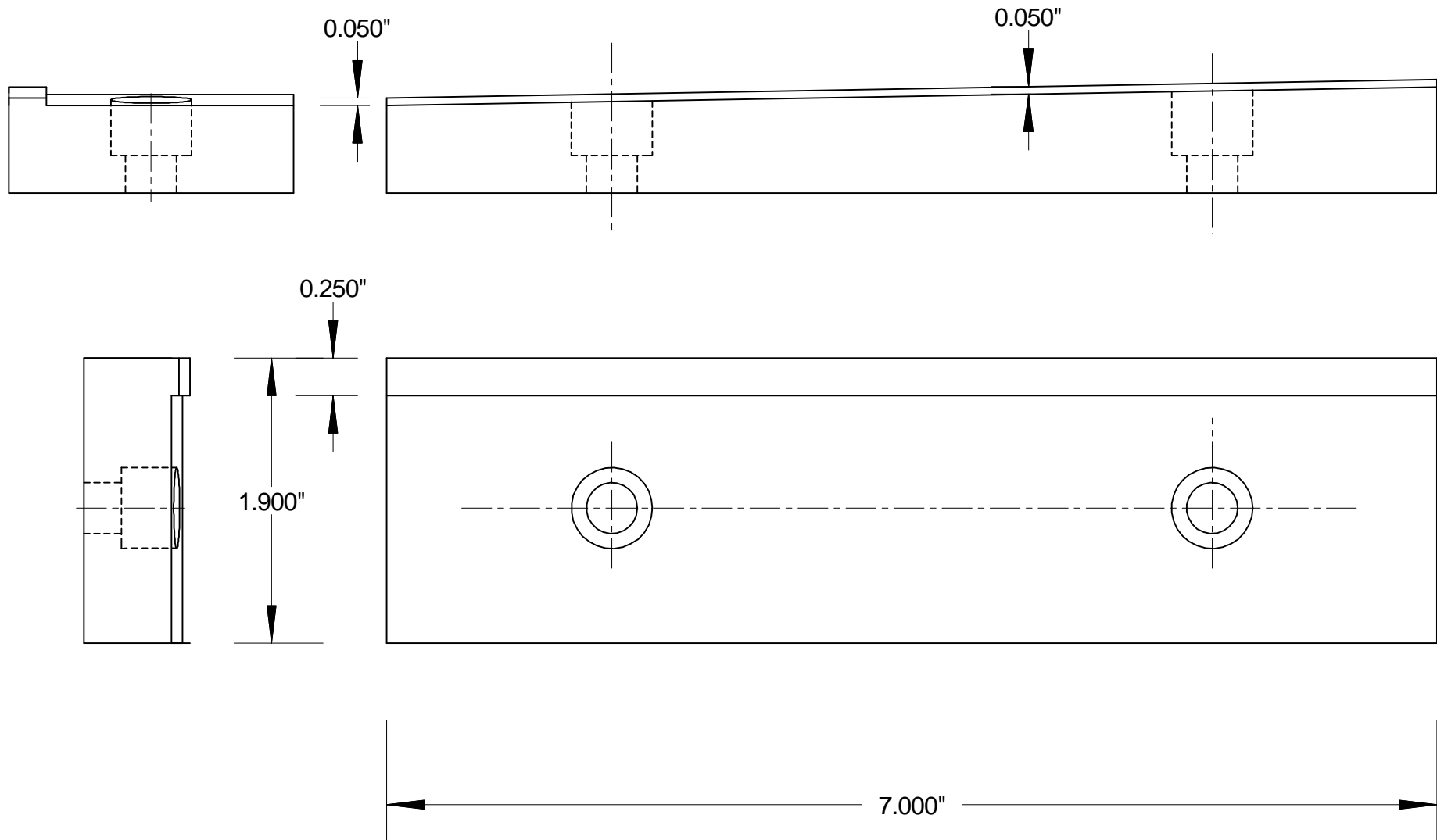

Taper approximately 1 degree, determined by thickness of spacer placed under one end of plate before milling top surfaces. Locating ridge left along one edge to aid in aligning gibs and brackets for milling.

Material: 3/4" alum. plate

Tapered Saddle Gib

Taper Milling Jig

06/29/01

Rick Kruger